

GTS TENSILE STRENGTH TEST FIXTURES

GTS grips and fixtures are used to determine the flatwise tensile strength and tensile adhesion properties. Fixtures are designed according to standards such as ASTM C297, ASTM D3354, ASTM D1623B, EN 1607, EN 2243-4, DIN 53292.

Available types include:

1. Model GTS can be used with samples up to 100x100 mm.
2. Model GTS-327 can be used with samples larger than 100x100 mm.

GTS

Single-axis and double-axis versions available for samples up to 100 mm by 100 mm

The fixture consists of one pair of loading block carriers and one pair of insert loading blocks. Carriers are available as a single-axis and a double-axis version (GTS-GT + GTS-2Axe-GT). Both carriers are suitable for all insert loading blocks. The test specimen is bonded to the face of insert blocks that are then pulled apart.

Standard adapters:	15.9 mm or 31.8 mm female eye ends. Other adapter options available to mount to non-ADMET UTM's.
Carrier and inserts:	Steel, nickel-plated
Standard temperature range:	-70°C to +350°C
Scope of delivery:	1 pair of carriers / 1 pair of inserts. Carrier and insert loading blocks should be ordered separately.

	ASTM C297	ASTM D3354	ASTM D1623B	EN 1607	EN 2243-4	DIN 53292	Insert block size:	Weight each:
Carriers								
GTS-GT	x				x			0.78 kg
GTS-2Axe-GT		x	x	x		x		1.30 kg
Insert blocks								
GTS-E50-25.4x25.4	x		x				25.4x25.4 mm	0.58 kg
GTS-E50-50x50				x	x	x	50x50 mm	0.71 kg
GTS-E50-50.8x50.8	x						50.8x50.8 mm	0.72 kg
GTS-E50-76.2x76.2	x						76.2x76.2 mm	0.98 kg
GTS-E50-100x100		x		x			100x100 mm	1.31 kg

Carriers



GTS-GT



GTS-2Axe-GT

Insert blocks



GTS-E50-50x50



GTS-E50-100x100

Example GTS Solutions:

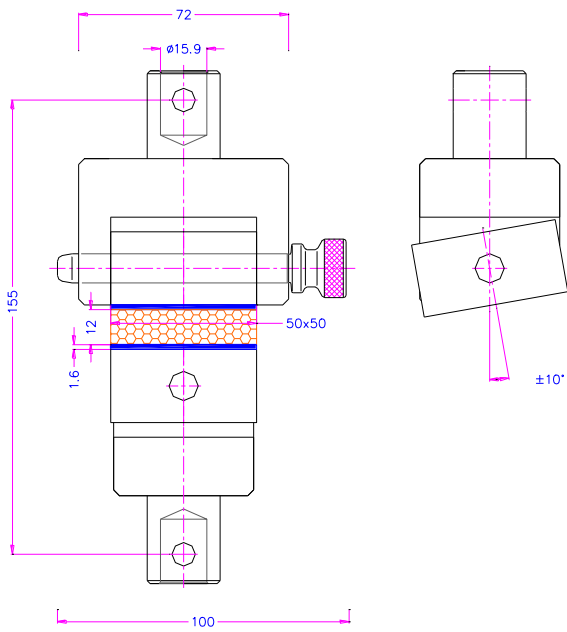

GTS-GT + GTS-E50-50x50 EN2243-4

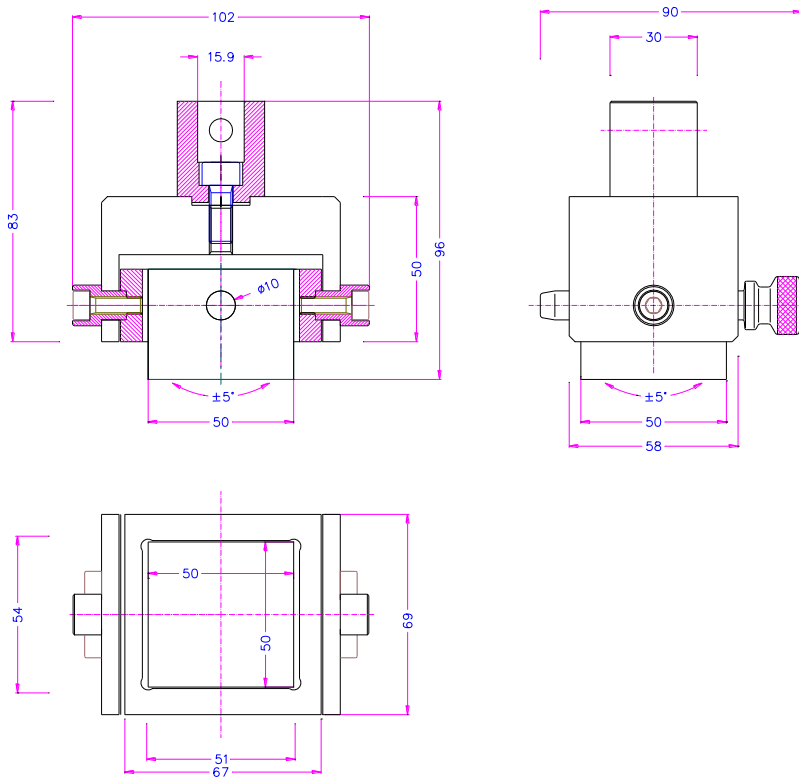

GTS-2Axe-GT + GTS-E50-50x50 EN1607

GTS-327

Double-axis version for larger samples (> 100 x 100 mm)

A test specimen is bonded between two rigid plates that are then pulled apart. Possible plate sizes include 100x100, 150x150, 200x200, and 300x300 mm.

The fixture consists of:

1. One pair of cardan (universal) joint adapters (See [Universal Joints](#) or contact ADMET for details)
2. One pair of connection adapters to connect the universal joint adapter and plate

- Standard adapters: 15.9 mm female eye ends.
Other adapter options available to mount to non-ADMET UTMs.
- Cardan joint and connection adapters: Steel, nickel-plated
- Plates: Aluminium
- Temperature range: -70°C to +180°C
- Scope of delivery: Plates, cardan joint adapter and connection adapter have to be ordered separately.



Model Number	ASTM D3354	EN 1607	Plate size:
GTS-327-P100x100	x	x	100x100 mm
GTS-327-P150x150		x	150x150 mm
GTS-327-P200x200		x	200x200 mm
GTS-327-P300x300		x	300x300 mm

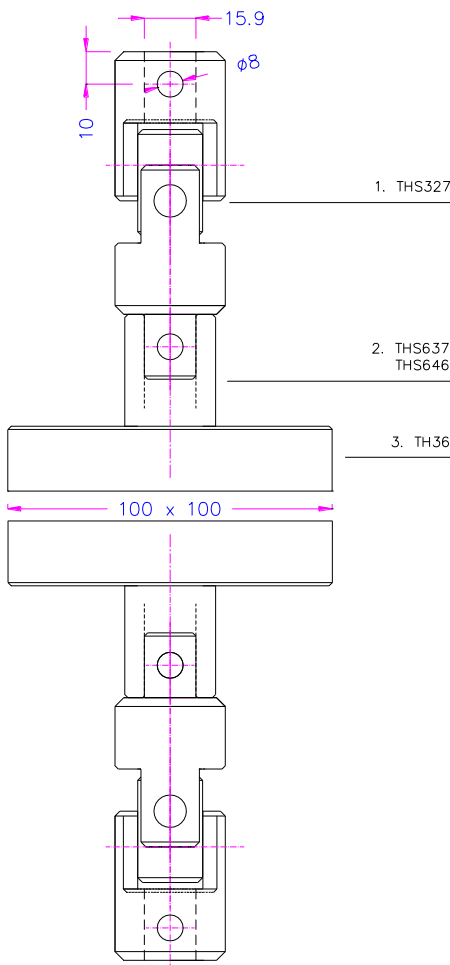

GTS-327-P100x100-Af159

Fixture for tests according to ASTM D3354 and EN 1607 for 100x100 mm samples, Af159 mm adapters



GTS-327-P100x100-Af159